

BGLED888

LED Barge Navigation Lights Parts List

PAGE 1



BGLED-HEAD-PORT

Complete head with Red LED array, lens, screen, circuit and plug.

BGLED-HEAD-STAR

Complete head with Green LED array, lens, screen, circuit and plug.

BGLED-HEAD-STERN

Complete head with White LED array, lens, screen, circuit and plug.

BGLED-HEAD-FL

Complete head with Amber LED array, lens, screen, circuit and plug.

BGCMPE

Steady control module with photoelectric control for port, starboard and stern steady lights only.

BGCMFLPE

Flashing amber control module with photoelectric control.

BGCMPEEP

Flashing amber control module with peep light.

BGLED888-STD-COVER-ASSY

Complete cover assembly, black cup, bezel, switch, contact plate, bale handle.

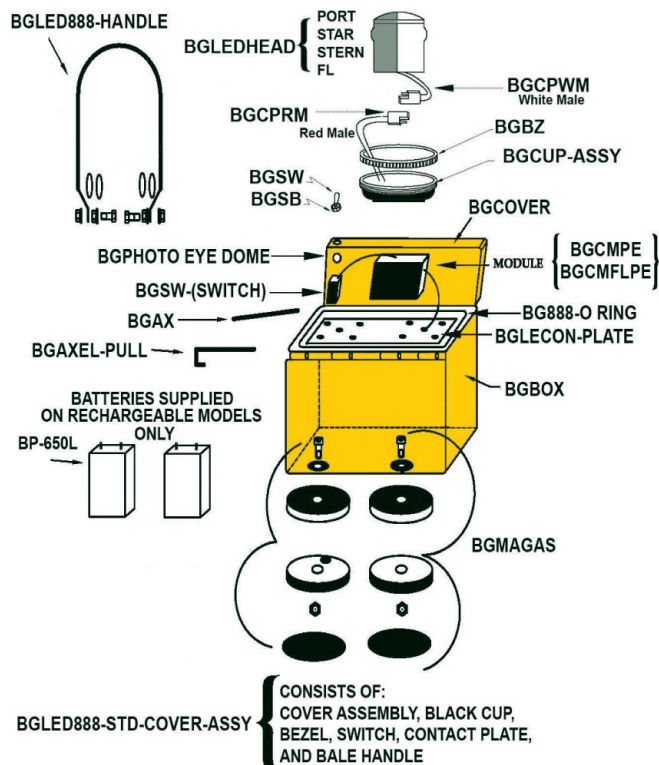

BGBZ

Black bezel for securing head to base.

BG888-ORING

18" silicone black o-ring.

BGCUP-ASSY

Black threaded cup assembly.

BGLED888-HANDLE

Black bale handle, 2 bolts, 4 washers, 4 nuts.

BGCOVER

Cover with black lens holder.

BGBOX

Raw yellow bottom.

BGMAGAS

Magnet assembly: 1 magnet, 2 washers, 1 nut, 1 screw and protective disc. (All stainless)

BGSW

On/Off toggle switch.

BGSB

Rubber boot for toggle switch.

BGPHOTO-EYE-DOME

Plastic see-thru dome for photo eye.

BGAXEL-PULL

Removable stainless steel pull pin.

BGAX

Stainless steel axle



**McDermott Light
& Signal**

BGLED888

LED Barge Navigation Lights Parts List

PAGE 2



BGLECON-PLATE

Battery contact plate with 2 brass eyelets.

BP-650L

Replacement rechargeable 6 volt spring top battery.

BGCPWM

6" wire with polarized plug with White as male.

BGCPRM

6" wire with polarized plug with Red as male.

BATTERY-509A

Alkaline spring top battery.

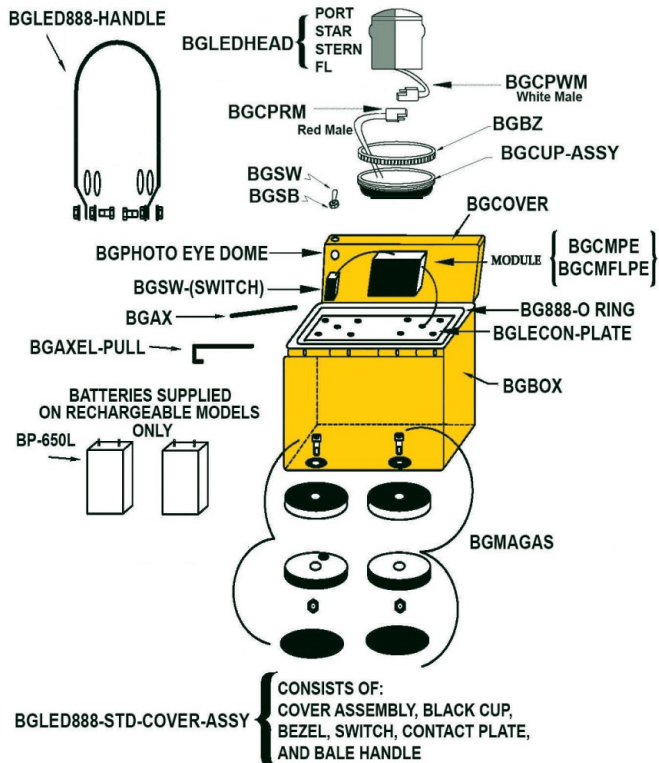

**McDermott Light
& Signal**